

BigBoys Bulk Systems

Proper Care and Use Guidelines

130 L CAPACITY
SHUTTLES

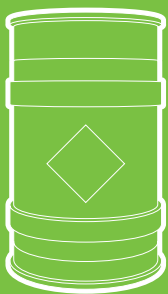
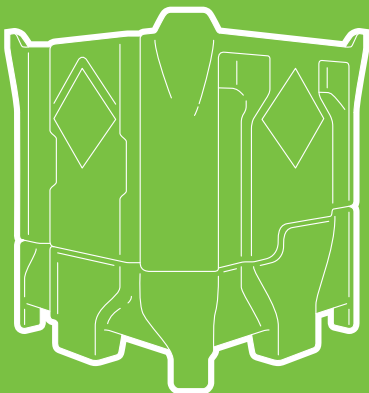

449 L CAPACITY
TOTES



Bayer CropScience

The System is in Your Hands







Bulk handling systems have really caught on as more and more growers adopt this simple and easy-to-use way to manage crop protection products.

Bayer CropScience is committed to bulk handling systems. Our tote and shuttle fleet system is best in class and allows for packaging of numerous products with varying capacities up to 130 L for shuttles and 449 L for totes. We want to ensure that you have access to this convenient, leading edge system for years to come.

This instruction pamphlet will describe how to ensure optimal performance when using any size of shuttle or tote system. You, the user, play an important role while these units are in your possession. By following the handling, set-up and

PRODUCT COLOUR CODES AND NET CONTENTS

The base of each shuttle or tote is colour coded according to the following to provide for easy visual identification. Each product contains different net content fill volumes, as identified below.

Container Base Colour	Product
	Buctril® M
	Infinity®
	Liberty®
	Puma® Advance
	Puma ¹²⁰ Super
	Thumper®
	Tundra™

maintenance procedures set out in this pamphlet, you will ensure that the overall system delivers several years of customer satisfaction. On the surface, the BigBoys bulk system may appear to be a lower-cost system considering the potential for 5-10 seasons of container use. However, each year these units require maintenance which is a substantial cost. In many cases these repairs can be prevented if used properly by the end user.

When the units are returned clean, undamaged and with seals intact, the process of an external wash, refill and shipment to the field is cost effective for you and Bayer CropScience. If the units are not returned, come back damaged, are missing parts or have seals broken, the turnaround time and costs of maintaining these units goes up accordingly. This adds to the cost of the product. More importantly for you, the grower, you risk losing your security deposit, cutting into your bottom line.

By following these simple but important steps outlined in this brochure, you become an integral part of sustaining the delivery system, saving you time and money over the years.

SHUTTLES		TOTES		
Fill Volume (L)	Acres Treated (ac.)	Fill Volume (L)	Acres Treated (ac.)	Weights (kg)
128.0	320	400.0	1,000	500.8
107.2	320	335.0	1,000	439.0
108.0	80	432.0	320	539.5
123.75	300	412.5	1,000	483.4
99.3	320	312.0	1,000	367.2
128.0	320	400.0	1,000	514.0
129.6	160	N/A	N/A	N/A

Note: All totes are the following dimensions 0.93 m x 0.93 m x 1.05 m

Shuttles Overview

TOP VIEW

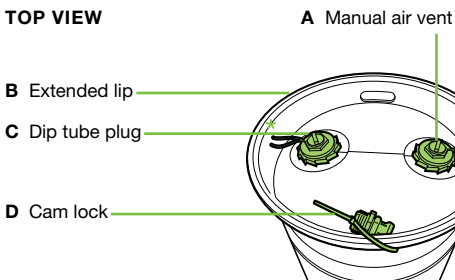

*Tamper proof wire seal

INTERIOR VIEW

- E Driptube
- F Self draining sump

Interior of the shuttle has a sump for maximum drainage. Do not break the seal, the shuttle is overfilled by 500 mL.

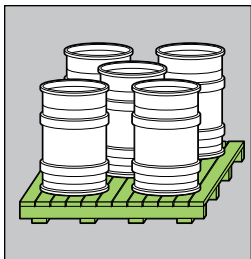
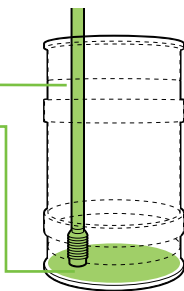

1 Shuttles are shrink-wrapped and shipped five to a pallet.

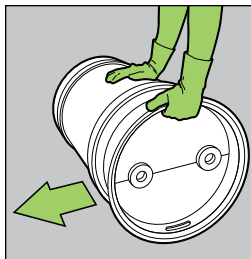

2 Shuttles can be rolled on their side.

Shuttles

Proper Use to Start

Inspect unit, check for damage, ensure tamper proof wire seals are intact.

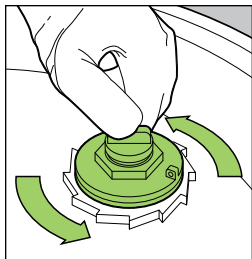

1 Rotate the manual air vent open by turning counter-clockwise until it is fully extended.

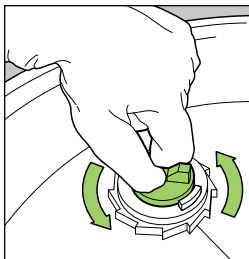

2 Unscrew and remove the dip tube plug by turning counter-clockwise.

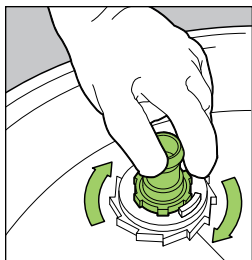

3 Screw the cam lock into the dip tube by turning clockwise.

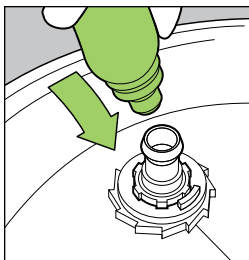

4 Connect the pump hose to the cam lock.

Shuttles

Proper Use When Done

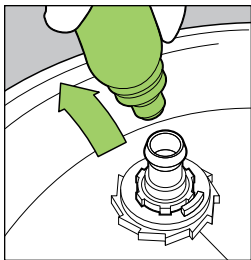

- 1 Disconnect the pump hose from the cam lock.

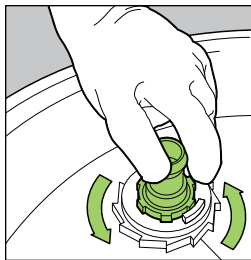

- 2 Unscrew the cam lock from the dip tube by turning counter-clockwise.

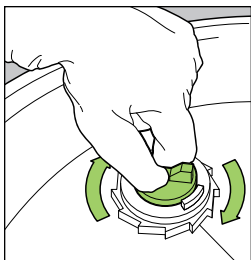

- 3 Replace the dip tube plug and screw closed by turning clockwise.

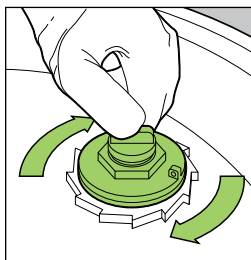

- 4 Rotate the manual air vent closed by turning clockwise.

Totes

Overview

TOP VIEW

A Manual air vents (2)

B Automatic air vent

C Tamper proof seals (3)

D Sling package location

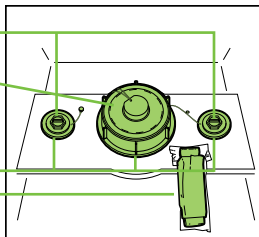

EXTRACTION HARDWARE VIEW

Extraction hardware is located behind the Bayer-branded door at the base of the unit.

E Valve

F Dust cap

G Dry break coupler

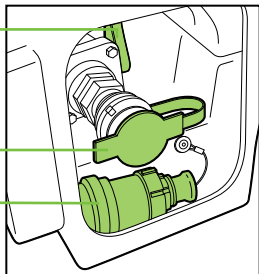

Interior of the tote is sloped for maximum drainage. Do not break the seal, the tote is overfilled by 500 mL.

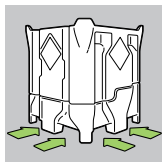

1 Proper forklift use.

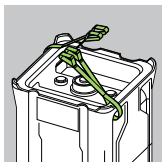

2 Proper use of straps/slings.

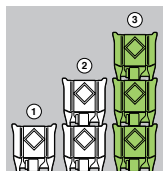

3 Stackable; three units high.

Totes

Proper Use to Start

Inspect unit, check for damage, ensure tamper proof wire seals are intact.

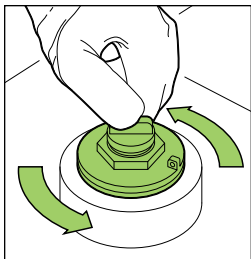

1 Rotate both manual air vents located on top of unit by turning counter-clockwise until fully extended.

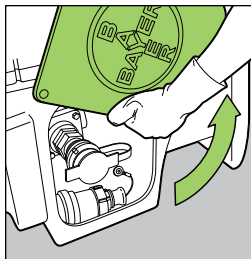

2 Find door located at base of unit. Cut plastic strap and rotate door open.

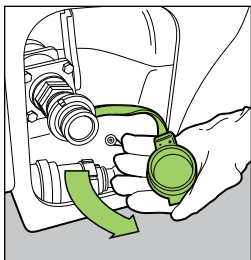

3 Remove the dust cap.

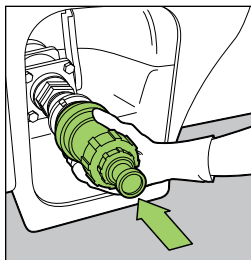

4 Connect the dry break. Do not cut the wire.

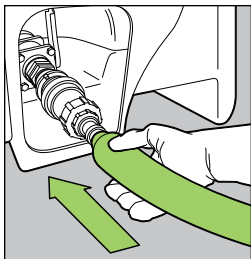

5 Connect the pump hose to the dry break.

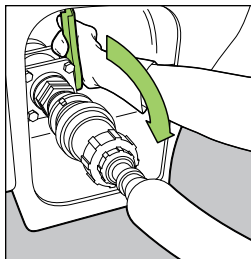

6 Rotate the one-way valve open.

Totes

Proper Use When Done

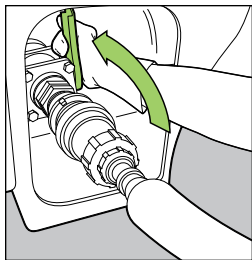

1 Rotate the one-way valve closed.

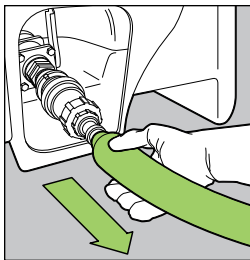

2 Disconnect the pump hose from the dry break.

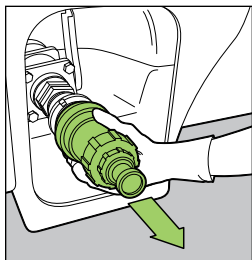

3 Remove the dry break and replace in base of unit.

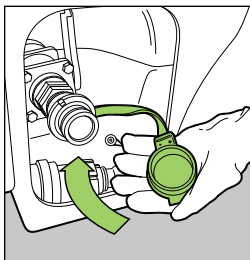

4 Replace the dust cap.

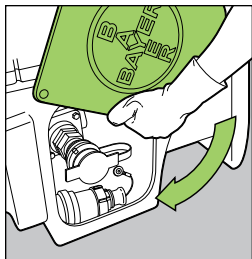

5 Rotate the door closed.

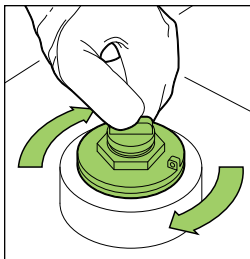

6 Rotate both manual air vents closed.

How NOT to treat your bulk delivery systems. These actions can void your deposit!

Once the units have been filled at our plant, we prevent access to the contents (interior of unit) by the application of wire, tamper-proof seals. When you take possession of the units, inspect for any damage and to ensure all seals are intact. This is your guarantee that the contents have not been compromised. While in your possession, you must not break these seals for any reason. If the units are returned with one or more broken seals, we must assume that the interior of the units could have been contaminated by the introduction of a foreign substance. Therefore, the units must undergo a rigorous cleaning process, a time consuming and costly exercise. Major damage constitutes a puncture or crushing that renders the unit unusable. In the case of totes the damage deposit lost will be \$500 while on shuttles the deposit lost is \$100.

When totes are returned without their couplers, the retail and subsequently the grower will be charged \$50 from deposit.

NOTE: There is no reason to break a seal. The units are sufficiently vented, are self draining and are overfilled by 500 mL to ensure you get full value.

Please do not damage the container – this may void your deposit.

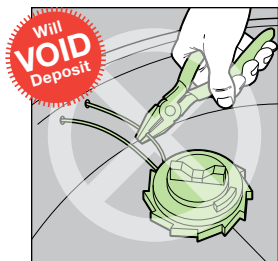

x **DO NOT** cut the wire seals on top of a shuttle.

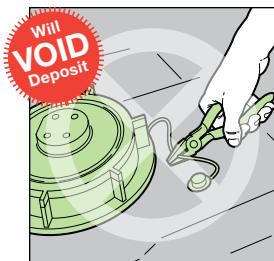

x **DO NOT** cut the wire seals on top of a tote.

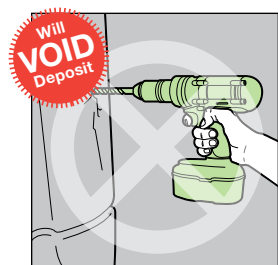

x **DO NOT** drill or puncture holes into any container.

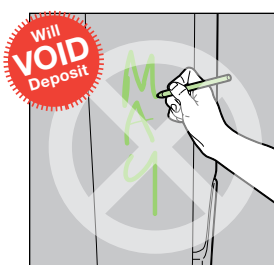

x **DO NOT** mark, paint or write on any container.

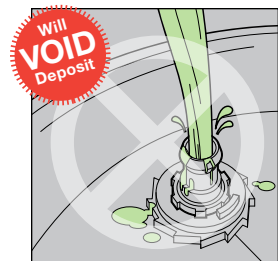

x **DO NOT** introduce foreign substances into containers or attempt to rinse.

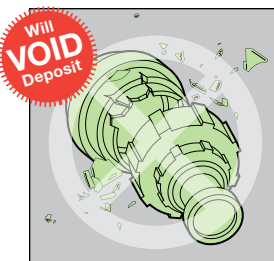

x **DO NOT** break or keep any parts, including dry break connectors and slings.

Effective January 1, 2011

Loss of Deposit Fees

Major Damage of Totes

Unit unusable – \$500

Example: • punctured
• crushed

Minor Damage of Totes

Not returning couplers – \$50

Major Damage of Shuttle

Unit unusable – \$100

Example: • punctured
• crushed

Returns

Please return empty container to your retailer. The retailer will arrange pick-up of empty containers with CWS Logistics at 1 866-748-8613. Please do not call Bayer CropScience directly.



Bayer CropScience

Suite 200, 160 Quarry Park Blvd. SE
Calgary, AB T2C 3G3

T. 1 888-283-6847 F. 1 888-570-9378
BayerCropScience.ca or contact
your Bayer CropScience representative.

Always read and follow label directions.
Buctril®, Infinity®, Liberty®, Puma®, Thumper®
and Tundra™ are trademarks of Bayer.
Bayer CropScience is a member of CropLife Canada.